

5050 DUFFERIN STREET
NORTH YORK, ONTARIO

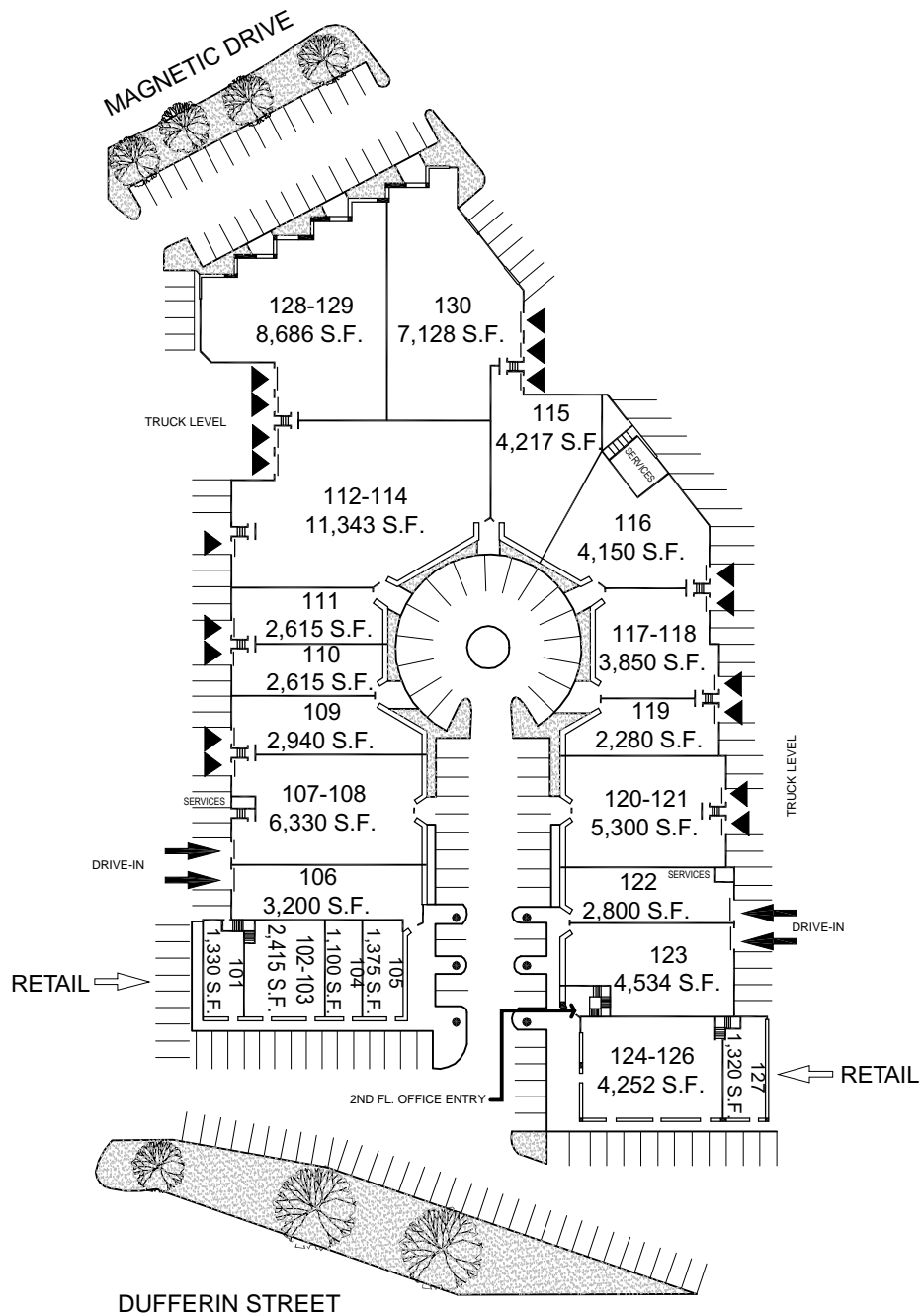

5050 Dufferin Limited
Managed by
Glen Corporation



GLEN CORPORATION

100 Scarsdale Road
Don Mills, Ontario M3B 2R8
Tel: 416-449-3300
Fax: 416-449-0392
www.glencorp.com

5050 DUFFERIN STREET
NORTH YORK, ONTARIO

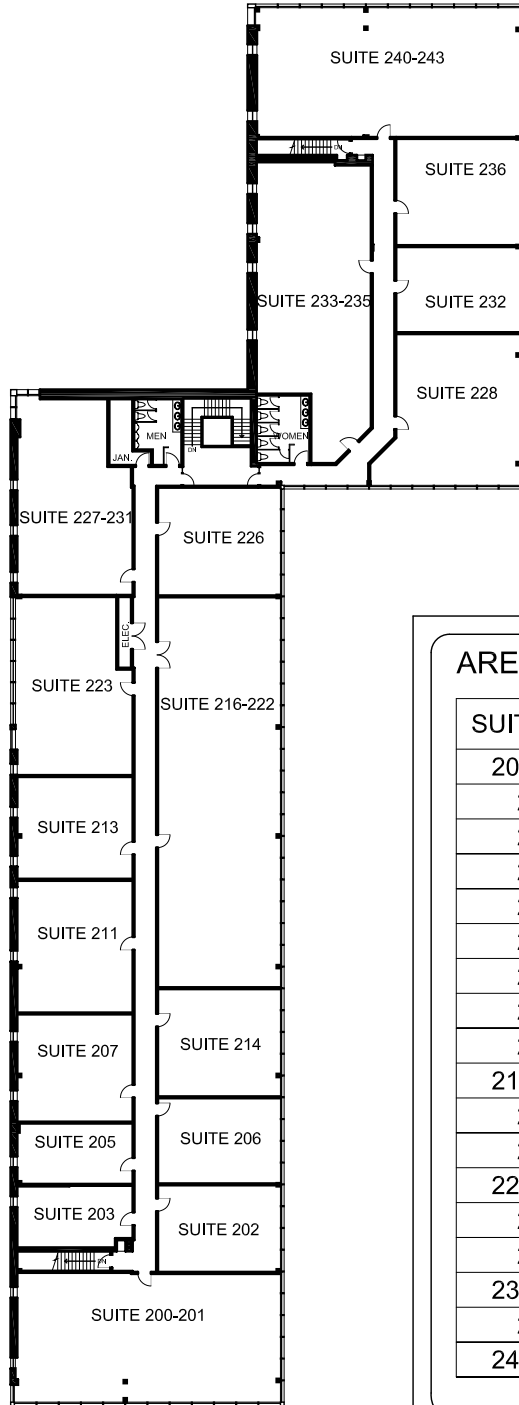

AREA SUMMARY

SUITE No.	RENTABLE AREA
200-201	2,072 S.F.
202	656 S.F.
203	425 S.F.
205	433 S.F.
206	644 S.F.
207	759 S.F.
211	929 S.F.
213	722 S.F.
214	808 S.F.
216-222	2,900 S.F.
223	1,212 S.F.
226	805 S.F.
227-231	1,268 S.F.
228	1,203 S.F.
232	652 S.F.
233-235	1,801 S.F.
236	810 S.F.
240-243	2,079 S.F.

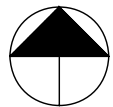

5050-Dufferin Limited
Managed by
Glen Corporation



GLEN CORPORATION

100 Scarsdale Road
Don Mills, Ontario M3B 2R8
Tel: 416-449-3300
Fax: 416-449-0392
www.glencorp.com